

# STAINLESS STEEL CAPPING TRACK

The **Stainless Steel Capping Track** is the inexpensive solution to those old, worn sliding door and window tracks. Repairing or replacing an old worn frame can be costly, time consuming and a risk to your security. The use of a capping track is cheap, simple to install and does not require you to remove your existing frame. All you do is select the capping track style which suits, cut it to size and fit it on top of your existing track. The result is a revived track and your door or window running like new!

### TECHNICAL SPECIFICATIONS

<b>Material:</b>	304 Grade S/Steel
<b>Length:</b>	2440mm ± 0.5mm
<b>Thickness:</b>	0.7mm
<b>Dimension tolerance:</b>	±0.5mm
<b>Bowing tolerance:</b>	10mm (full length)

#### Example of use of capping track:

Old door track example showing a worn and pitted track section

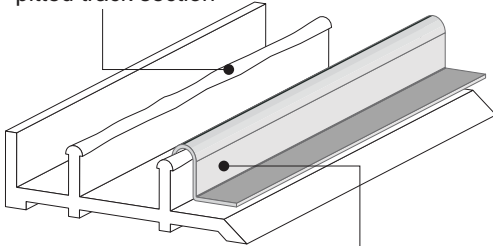

Example of capping track in situ

Capping track may be fitted using a suitable adhesive applied along the entire underside of the capping track or by drilling and screwing through the bottom fin and into the frame substrate.

A thorough clean and a light sanding prior to fitting is recommended for best results.

It is also advisable to check the condition of your rollers and replace in pairs if required.

#### CAPPING TRACK RANGE

- TT60100** 50mm Sample set of each track
- TT60200** 14mm x 2.8mm radius concave wheel
- TT60300** 10mm x 2.8mm radius concave wheel
- TT60500** 18mm x 2.8mm radius concave wheel
- TT60600** 15mm x 1.5mm radius concave wheel
- TT60700** 9mm x 1.5mm radius concave wheel
- TT60800** 7mm x 2.8mm radius concave wheel

#### TT60500

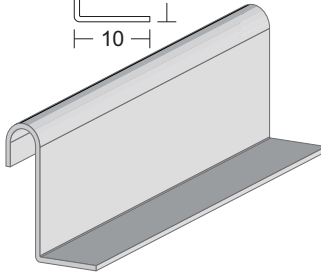
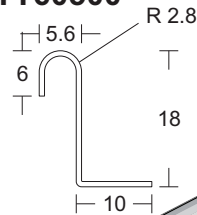

#### TT60200

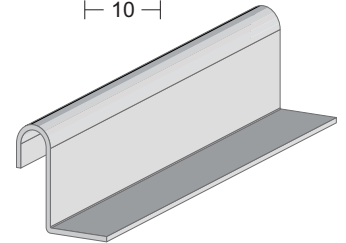
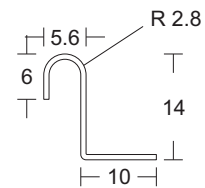

#### TT60300

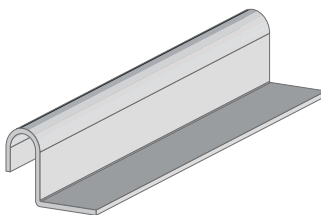
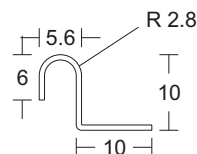

#### TT60800

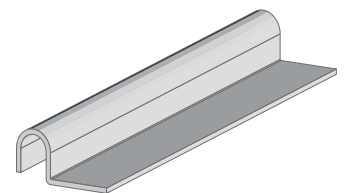
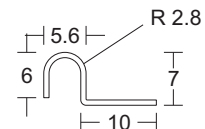

#### TT60600

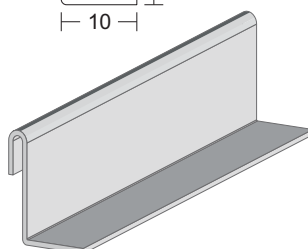
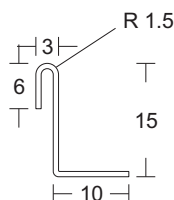

#### TT60700

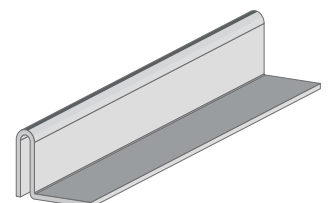
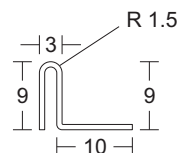

Shapes are indicative only and may vary slightly  
All dimensions are in mm